

- Tube Fitting (Double Ferrule)-
Tube To Tube

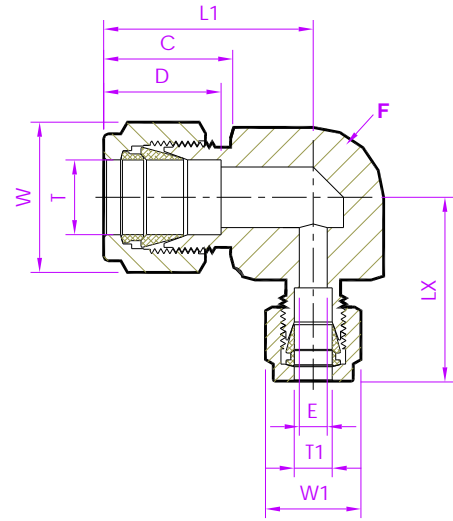

Reducer Union Elbow

Fractional Tube x Fractional Tube

Tubefit Part No.	Equivalent Part No. Type 1	Equivalent Part No. Type 2	TUBE OD Ø T	TUBE OD Ø T1	ØE	D	C	L1	LX	Body Hex F	Nut Hex W	Nut Hex W1	
Dimensions in Inches													
3 - RUED - 2	-----	3 - 2 ELZ	3/16	1/8	0.09	0.54	0.63	0.96	0.92	1/2	1/2	7/16	
4 - RUED - 2	-----	4 - 2 ELZ	1/4	1/8	0.09	0.60	0.70	1.06	0.96	9/16	9/16	7/16	
5 - RUED - 2	-----	5 - 2 ELZ	5/16	1/8	0.09	0.64	0.73	1.17	1.04	9/16	5/8	7/16	
5 - RUED - 4	-----	5 - 4 ELZ		1/4				0.19	1.17			1.14	9/16
6 - RUED - 2	-----	6 - 2 ELZ	3/8	1/8	0.09	0.66	0.76	1.20	1.04	11/16	11/16	7/16	
6 - RUED - 4	-----	6 - 4 ELZ		1/4				0.19	1.20			1.09	9/16
8 - RUED - 4	-----	8 - 4 ELZ	1/2	1/4	0.19	0.90	0.86	1.42	1.25	13/16	7/8	9/16	
8 - RUED - 5	-----	8 - 5 ELZ		5/16				0.25	1.42			1.28	5/8
8 - RUED - 6	-----	8 - 6 ELZ		3/8				0.28	1.42			1.31	11/16
10 - RUED - 6	-----	10 - 6 ELZ	5/8	3/8	0.28	0.96	0.86	1.43	1.32	7/8	1	11/16	
10 - RUED - 8	-----	10 - 8 ELZ		1/2				0.41	1.43			1.43	7/8
12 - RUED - 4	-----	12 - 4 ELZ	3/4	1/4	0.19	0.96	0.86	1.56	1.38	1.1/16	1.1/8	9/16	
12 - RUED - 6	-----	12 - 6 ELZ		3/8				0.28	1.56			1.45	11/16
12 - RUED - 8	-----	12 - 8 ELZ		1/2				0.41	1.56			1.56	7/8
14 - RUED - 4	-----	14 - 4 ELZ	7/8	1/4	0.19	1.02	0.86	1.76	1.51	1.1/4	1.1/4	9/16	
16 - RUED - 8	-----	16 - 8 ELZ	1	1/2	0.41	1.23	1.04	1.94	1.62	1.3/8	1.1/2	7/8	
16 - RUED - 12	-----	16 - 12 ELZ		3/4				0.62	1.94			1.76	1.1/8

NOTE : 1)The E Dimension is the minimum opening. 2)Dimension L1, C, D is shown in the finger-tight position.
3)Dimensions are for reference only and are subject to change.